

Step into the capsule, we're blasting off...  
 This vision was simply a figure of our imaginations five years ago, a device people would dream about.  
 Now anybody can blast off in their very own residential capsule.  
 The **pneumatic vacuum elevator** is the first residential elevator that runs merely by the forces of gravity.

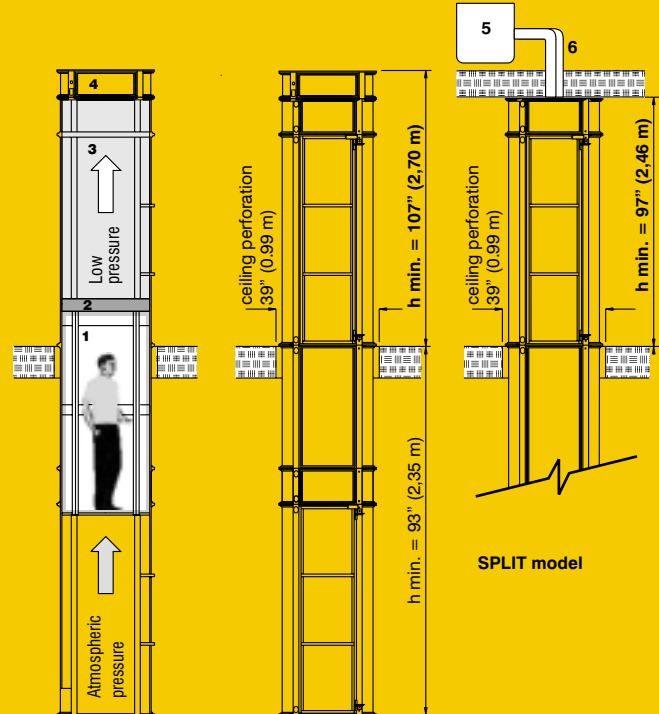

- 1- Atmospheric pressure zone
- 2- Seal on cabin
- 3- Low pressure zone
- 4- Vacuum pump

- 5- Vacuum pump's box  
29" x 18" x 21"
- 6- PVC's pipes Ø 4½"

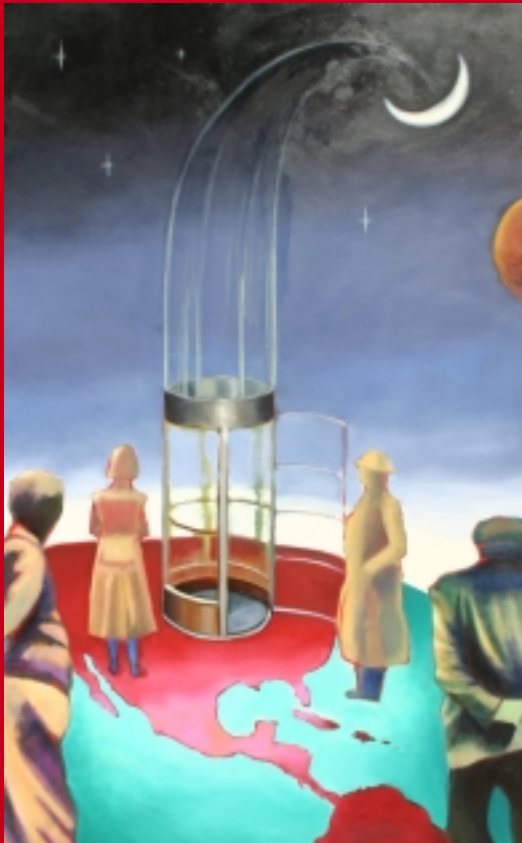